

## RAFFLE

BID ON SOME TREASURES

Do you have items to donate?????  
Email Ellie to let her know what you will be able to donate.

[ellies@hughes.net](mailto:ellies@hughes.net)

## REVISED PREMIUM NOTE CHANGE IN JUDGING PANEL

**BECAUSE OF THE WET OREGON  
WINTER, THE PARKING AREA IS  
SOFT. IF YOU WANT TO CAMP  
WITH AN R/V, PLEASE CONTACT  
ANN BILLUPS BEFORE THE TRIAL**

## Note Important Changes to AKC Lure Coursing Regulations

Italian Greyhounds can now run for Best in Field  
American Sighthound Field Association (ASFA) Qualification  
Certificate are now accepted by AKC in place of the AKC  
Qualified Courser Certificate. Proof of certification required  
if this is your first AKC trial.

## American Kennel Club ALL BREED LURE COURSING - QC Certification, JC TEST & TRIAL

### Event#s

2017098807 May 20 QC Cert., Trial and JC Test	2017098808 May 21 QC Cert., Trial and JC Test
--	--

**QC Certifications, JC Tests and Trials on Saturday May 20  
and Sunday May 21, 2017**

**Early Entry is Strongly Encouraged.**  
Pre-Entries close: 6:00 p.m. Wednesday, May 17, 2017

**Held by:**  
**Chintimini Kennel Club**  
An AKC Member Club



**May 20 and 21, 2017**  
**Billups' Ranch**  
**71273 London Rd. Cottage Grove, Oregon 97424**



Permission has been granted by the American Kennel  
Club for holding of this event under American Kennel  
Club Rules and Regulations.

**Entry Fees:**

Pre-Entry J.C. Test Per Hound	\$22.00
Pre-Entry QC Certs.	\$22.00
Pre-Entry Trial, First Hound	\$22.00
Pre-Entry Trial, Any additional hound (same owner)	\$18.00
All pre-entry fees for Junior Handlers (per hound)	\$5.00
Day of Event QC Certs/Test/Trial (each hound)	\$25.00
Day of Event Trial for dogs completing QC	Pre-entry rate
All day of entry fees for Junior Handlers (per hound)	\$10.00

[http://www.akc.org/events/lure\\_coursing/eligible\\_breeds.cfm](http://www.akc.org/events/lure_coursing/eligible_breeds.cfm). Note: Italian Greyhounds are *now* eligible to compete for Best in Field. FSS breeds are not eligible to compete for Best in Field. Eligible dogs must be either individually registered with AKC, recorded with the Foundation Stock Service (FSS), individually registered with a foreign registry organization whose pedigrees are acceptable for AKC registration, or that have been granted a Purebred Alternative Listing (PAL/ILP).

**Judges & Assignments:**

#1 Ann Billups (Judge's # 26652) 71273 London Rd. Cottage Grove OR 97424;  
#2 Rosemary Marnoch (Judge's # 93249) PO Box 837, Mayer AZ 86333-0837

**Judges' Assignments**

	Judge 1	Judge 2
JC	Sat	Sun
QC	Sun	Sat
Afghan	Sat/Sun	Sat
Basenji	Sat/Sun	Sat
Borzoi	Sat/Sun	Sat
Greyhound	Sat/Sun	Sat
Ibizan Hound	Sat/Sun	Sat
Irish Wolfhound	Sat/Sun	Sat
Italian Greyhound	Sat/Sun	Sat
Pharaoh Hound	Sat	Sat/Sun
Rhodesian Ridgeback	Sat	Sat/Sun
Saluki	Sat	Sat/Sun
Scottish Deerhound	Sat	Sat/Sun
Whippet	-	Sat/Sun
Azawakh	Sat	Sat/Sun
Cirneco Dell 'Etna	Sat	Sat/Sun
Peruvian Inca Orchid	Sat	Sat/Sun
Portugese Podengo – grande	Sat	Sat/Sun
Portugese Podengo – medio	Sat	Sat/Sun
Portugese Podengo - pequeno	Sat	Sat/Sun
Sloughi	Sat	Sat/Sun
Thai Ridgeback	Sat	Sat/Sun
Norrbottenspets	Sat	Sat/Sun
Singles Stakes	Sat	Sat/Sun

**Phone, fax, and email entries will NOT be accepted.**  
**Send entries to Lorain Abel 108 NE Steiger St. Grants Pass**  
**OR 97526**  
**Make Checks Payable to: Chintimini Kennel Club**  
*Entries will not be acknowledged by mail.* Entries acknowledged electronically if email address is legible on entry form.  
***Please mail early. Late, incomplete, unsigned, unpaid, or conditional entries will not be accepted.***

**CHINTIMINI KENNEL CLUB****Officers:**

President: Linda Eng; Vice President: Karen Ahonen; Corresponding Secretary: Katie Dugger; Recording Secretary: Mary Ann Sward; Treasurer: Cindy Frederick; Board: Jeff Hunter, David Hagey, and Karen Houle.

**KKC Field Committee:**

**Field Chairmen:** Carol West\*, 2821 Maywood Dr. Forest Grove, OR, 97116  
503-5501678; cwwwest@gmail.com

**Field Secretary:** Lorain Abel\*, 108 NE Steiger St. Grants Pass, OR, 97526  
541-472-1736; [lorain@cedarviewvet.com](mailto:lorain@cedarviewvet.com)

**Field Clerk:** Kristen Nelson\*

**Lure Operators:** Nick Pisas\* and Keith Stevens

**Hunt Masters:** Sue Pisas\*, Bonnie Cooley, and Carol West

**Paddock Master:** Kathleen Kennett

**Inspection:** Linda Stewart and D'Gaye Findlay

**Re-stringer:** Jennifer Weikel

**\*Field Committee Members****Eligible Breeds & Registry:**

Lure Coursing tests and trials shall be open to eligible breeds one year of age or older. For a complete listing of the breeds eligible to participate in the AKC Lure Coursing program, please visit the AKC website at:

## Professional Photography

By

## So Fly Photography

<http://sofly.smugmug.com>

### Anticipated Running Order

Both Days— Afghan, Basenji, Borzoi, Greyhound, Ibizan Hound, Irish Wolfhound, Italian Greyhound, Pharoah Hound, Rhodesian Ridgeback, Saluki, Scottish Deerhound, Whippet, Azawakh, Cirneco Dell 'Etna, Peruvian Inca Orchid, Portugese Podengo – grande, Portugese Podengo – medio, Portugese Podengo – pequeno, Sloughi, Thai Ridgeback, Norrbottenspets, Singles Stakes

### Event Schedule:

Event	Hours	Entry Close	Roll Call and Start	Start of Rolling Inspection
Saturday QC Cert.	8AM to completion	9AM	9:15AM	8:45AM
Saturday Trial	8AM to completion	9:45 or 15min after QC's end whichever is latest	10:00AM	8:45AM
Saturday JC Test	Completion of Trial final runs to completion of Tests	2PM	After completion of trial final runs	1PM
Sunday QC Cert.	7AM to completion	8AM	8:15AM	7:45AM
Sunday Trial	7AM to completion	8:45 AM or 15min after QC's	9:00AM	7:45AM
Sunday JC Test	Completion of Trial final runs to completion of Tests	1PM	After completion of trial final runs	12PM

ALL HANDLERS **MUST BE PRESENT** FOR ROLL CALL, INSPECTION AND ANNOUNCEMENTS

Any dog not present 5 minutes after roll call will be considered absent.

**All dogs will be inspected prior to roll call on each day**

### Test and Stakes Offered:

**JC TEST** (Saturday Only): Open to all hounds of an eligible breed one year or older on the day of the test. (See AKC Lure Coursing Rules and Regulations for any disqualifications that may apply). A hound running alone shall receive a certification from a Judge on one date and a second certification from a different Judge at a later date, stating that the hound completed a 600 yard course with a minimum of (4) turns. The hound must complete the course with enthusiasm and without interruption.

**QUALIFIED COURSER CERTIFICATE:** Open to a hound at least 12 months of age running with another hound of the same breed—or another breed with a similar running style. The hound must complete the course with enthusiasm and without interruption, sufficiently course the lure and not course the Testing Hound. The judge will certify that the Qualifying Hound ran cleanly and did not appear to present a hazard to the Testing Hound at any point in the qualifying course. This certificate is required to enter a hound in an Open Stake. The handler presenting the Qualifying Hound **SHALL BE RESPONSIBLE FOR PROVIDING THE TESTING HOUND FOR THE QUALIFYING COURSE.**

**IT IS STRONGLY RECOMMENDED THAT EVERY QUALIFYING HOUND HAVE BEEN RUN PREVIOUSLY IN PRACTICE AND THAT TO THE HANDLER'S SATISFACTION RUNS CLEANLY AND KEENLY WITH OTHER HOUNDS.**

**OPEN:** Open to all hounds that have obtained an AKC Qualified Courser certificate or have an American Sighthound Field Association (ASFA) qualification certificate. This requirement will be waived for hounds that have earned a Field Championship title from the Canadian Kennel Club (CKC). CKC Field Champions must submit a copy of their title certificate to the host club when they enter their first AKC Open Stake. This copy must be included when the results of the trial are sent to AKC. Dogs with ASFA qualification certificates must also provide a copy to be submitted to AKC. Championship points earned from the Open Stake will only count toward a Field Champion title. Hounds that have earned an AKC Field Championship title are not eligible to enter the Open Stake.

**OPEN VETERENS:** Open to all hounds which are eligible to enter Open or Special Stakes and meet the age requirement for a veteran as established by the breed's parent club- 6 years of age; except Irish Wolfhounds = 5 years, and Whippets = 7years. Championship points will be awarded. Points won from the Veteran Stake may count toward either a Field Championship title or Lure Courser Excellent title.

**SPECIALS:** Open to all hounds that have earned their AKC Championship titles.

Championship points earned from the Specials Stake will count toward Lure Courser Excellent titles. Qualifying scores earned from the Specials Stake will count toward a Senior Courser or Master Courser title.

**SINGLES STAKES:** Open to all hound breeds approved to participate in AKC Lure Coursing trials. Hounds with breed disqualifications are eligible to enter. Hounds entered in the Singles Stake shall not be allowed to enter the regular stakes (open, specials or veteran) at the same event.

**BEST IN FIELD WILL BE OFFERED.** Open to all AKC Recognized Breed Best of Breed winners with the exception of FSS breeds.

### **Ribbons & Prizes:**

**QC Certification:** In addition to Certification, all entrants in QC will receive a toy or dog item.

**TEST** Dark Green flat ribbon for qualifying score. All entrants in the Test will receive a toy or dog item.

**TRIAL** Ribbons for all placements. Rosettes for Best of Breed and Best In Field; **SATURDAY'S & SUNDAY'S BEST IN FIELD** Award is a Blue Spruce pottery piece offered by KKC.

**CKC will award a special rosette to dogs completing a championship at these trials.**

### **General:**

1. All entries must be one year of age or older on the day of the test or trial.
2. Stakes will be split by public random draw if the entry in any one stake is sufficient to hold two or more five-point majors.
3. In the Trial, all hounds will run twice unless excused, dismissed, or disqualified.
4. Hounds not present at the time of roll call will be scratched after a five (5) minute grace period. Each entry will be examined at inspection for breed disqualifications. Bitches in season and lame hounds will be excused. Entry fee for hounds excused, during inspection, for bitches in season, lameness or breed disqualification shall be refunded. Spayed or neutered hounds, without breed disqualifications, may be entered.
5. Gasoline and electric powered drag lure machines, with back-up equipment, will be used in trials. Lure will consist of white plastic bags.
6. The course will be reversed for the finals.
7. The field committee reserves the right to alter the course plan as required by weather and/or field conditions on the day of the trial.
8. The field committee reserves the right to bar known aggressive hounds from the trial site.
9. There will be a \$5 fine assessed for any loose hound not taking part in the course in progress, or for anybody caught not picking up after their dog or leaving garbage on the field.
10. NO ONE will be allowed on the field without the express permission of the field chairman, except the appointed field committee.
11. Anybody exhibiting unsportsmanlike behavior will be excused from the field and

may be subject to further disciplinary action.

**12. Control of dogs strictly enforced, on leash at all times except when running.**

**13. Clean up and carry out all trash.**

**14. Please pick up all dog feces** and remove with trash or put in receptacle provided at site.

### **Veterinarians on Call:**

#### **Forest Valley Vet Clinic**

2555 Mosby Creek Road, Cottage Grove, Or. 541-942-9132

Call first, identify yourself as being from the Lure Coursing event.

This vet has regular office hours 8am to 6pm Friday and 8am to 1 pm Saturday.

Directions: go north on London Road 14 miles to I-5 freeway. Turn right to enter freeway northbound. Take first off-ramp, Exit 174. Turn left on Row River Road. Turn right on Thornton Road, then left on Mosby Creek Road. The Clinic is the second building on right.

**Call Emergency Vet Hospital after 1pm Saturday and all day Sunday.** 103 West Q Street, Springfield, Or. 541-746-0112 (provides 24-hour service)

Directions: go north on London Road 14 miles. Turn right onto I-5 north. Take I-5 north to Highway 126 east. Take 126 east to Springfield City Center Exit.

Exit freeway, turn left under freeway. Turn left onto Q Street, Hospital is 3<sup>rd</sup> building on left.

### **Accommodations:**

Holiday Inn Express 1601 Gateway Blvd, Cottage Grove, 97424 - (541) 942-1000

Comfort Inn Cottage Grove 845 Gateway Blvd, Cottage Grove, 97424 - (541) 942-9747

Super Eight Creswell/South Eugene 345 East Oregon Ave. Creswell OR, 97426 (541) 895-3341 (10 minutes from Cottage Grove).

Super Eight 3315 Gateway, Springfield 97477 – (541) 746-1314 (21 miles north of Cottage Grove).

R/V Park at Village Green Resort, 725 Row River Rd, Cottage Grove, 97424 – (541) 343-7666

**R/V and Camping Cottage Grove Lake, Pine Meadows Campground (541) 942-5631**

## **Hospitality Plans**

**Potluck Lunch on Saturday and Sunday**

## **CAMPING**

**Camping will be allowed at the site. Space is limited for small (less than 30') R/V's and tent camping on the field. No waste dump is available. Participants with R/V's Must contact Ann Billups 71273 London Rd., Cottage Grove OR 97424, 541-767-3653 by Monday May 15<sup>th</sup> about parking; [abillups@mac.com](mailto:abillups@mac.com).**

### **Note**

**The Billups' Ranch is 15 miles from I-5. No cell phone coverage at site. Please plan accordingly.**

### Course Plan Saturday

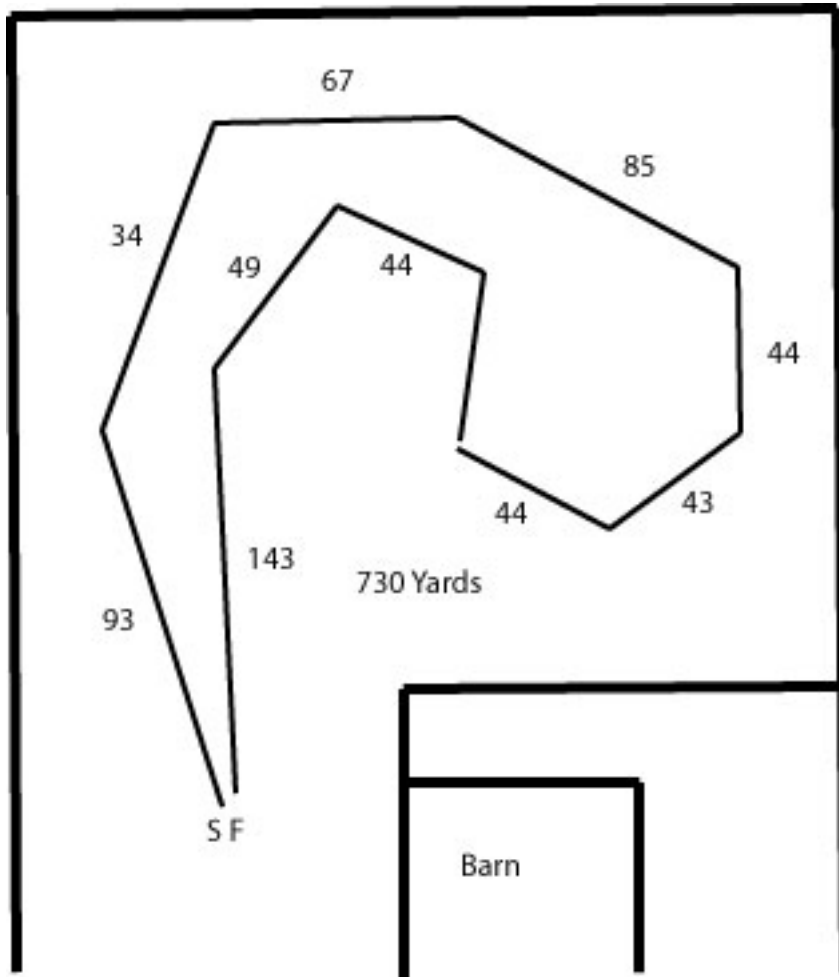

### Course Plan Sunday

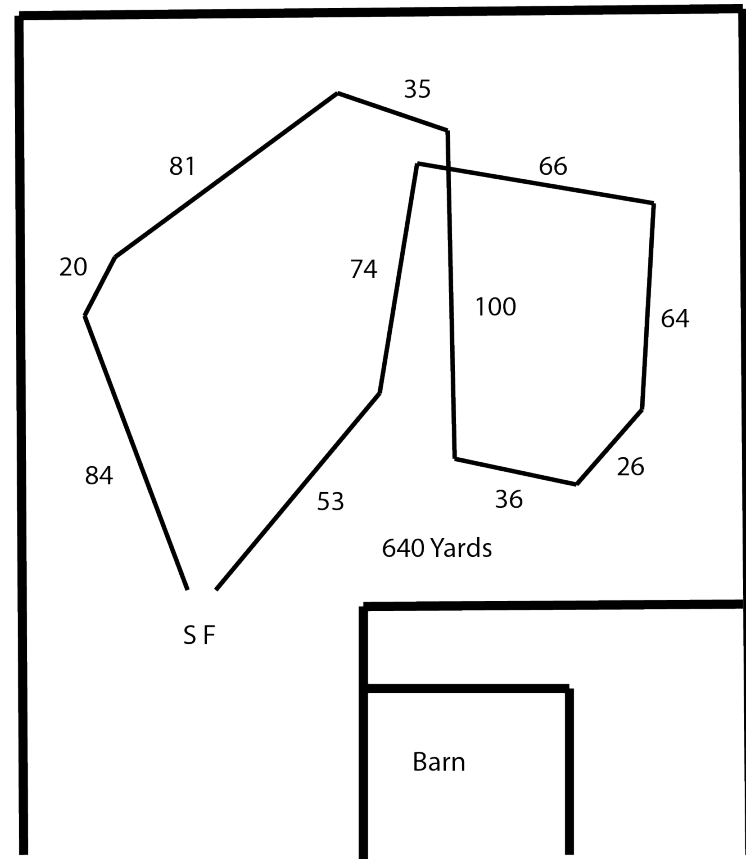

## **How to use QC Certification and Trial Entry Forms**

**Please remember to complete a separate entry form for each dog, for each event. Unlike conformation show entry forms you must use a separate form for each event and each dog. Thus, if you enter 3 dogs for Saturday and 1 for Sunday you need to submit 4 entry forms and 4 entry fees. A MS-Word version of the Trial/Test/QC Entry form is available on the Chintimini Kennel Club website:**

**([www.chintiminikennelclub.com/showresources.html](http://www.chintiminikennelclub.com/showresources.html))**

***Be sure you have the correct event number on your entries!!! Each day has a different event number!***

**For QC Certification we recommend that you complete two forms for each dog. One form must be submitted with your trial entry form and one QC form is for your records.**

### **Field Condition:**

Fully fenced pasture grass field with natural barriers and field fencing. Parking will be on grass field. Water is available on site..

## **DETAILED DIRECTION TO SITE**

### *Traveling South on I-5*

Exit Cottage Grove, 6th Avenue Exit 172.

Turn left and go over freeway. Follow 6th Avenue down the hill and veer toward the left.

\*Sixth Avenue has now become London Road. Follow London Road to mile marker 13. The mile markers are small signs on the side of the road. Right after mile marker 13, you cross a bridge. About 1/2 mile past the bridge, there are 3 mail boxes on the right side of the road. Directly opposite the mail boxes, is a gravel road. Turn left onto that road. Follow the gravel road about 1/4 mile to the Y intersection. Take the left part of the Y. Immediately after the Y, is a driveway on the left, do not take that. Follow the road straight until you come to a stop sign and the Whippet Watch sign. Go straight into the front yard.

If you are here for a lure trial or practice, turn left immediately after the stop sign and follow the gravel road down to the field. The pasture gate will be open, and we will be running right next to the barn. Parking is right next to the barn, or next to the horse pens depending on the number of people who show up. If it is wet, please park on the gravel drive, as the ground in horse pasture can get very soft.

### *Traveling North on I-5*

Take the first Cottage Grove Exit south of town, Exit 170.

You will follow the road left over the freeway, and drive parallel to the freeway for about 2 miles. At Latham, turn right. There is a Weyerhaeuser lumber mill on the north corner, turn before the lumber mill. Follow Latham back under the freeway until it dead ends at 6th Avenue. Turn right. Follow directions above from \*

**OFFICIAL AMERICAN KENNEL CLUB LURE COURSING ENTRY FORM**

Club: <b>Chintimini Kennel Club</b>		Date:	Event #:		
Location: <b>Billups' Ranch 71273 London Rd. Cottage Grove, OR 97424</b>		Event type: <input type="checkbox"/> Test <input type="checkbox"/> Trial	I Enclose Entry fees in the amount of : \$ _____		
Class: <input type="checkbox"/> JC <input type="checkbox"/> QC <input type="checkbox"/> Open <input type="checkbox"/> Special <input type="checkbox"/> Veteran <input type="checkbox"/> Single		Breed:			
Breeder:		Reg./List. No:	Sex:	Date of Birth:	
<input type="checkbox"/> AKC No. <input type="checkbox"/> AKC Litter No. <input type="checkbox"/> PAL/ILP No. <input type="checkbox"/> Foreign No. & list country <input type="checkbox"/> Canine Partners.					
Full Name of Dog:			Call Name:		
Sire:					
Dam:					
Actual Owner(s):					
Owner's Address:					
City:		State:	Zip:		
Name of Owner's Agent/Handler (if any at Trial):					
AKC Rules, Regulations, Policies and Guidelines are available on the American Kennel Club website: <a href="http://www.akc.org">www.akc.org</a> <b>AGREEMENT</b> I CERTIFY that I am the actual owner of this dog, or that I am the duly authorized agent of the actual owner whose name I have entered above. In consideration of the acceptance of this entry, I (we) agree to abide by the rules and regulations of The American Kennel Club in effect at the time of this trial, and by any additional rules and regulations appearing in the premium list for this trial, and entry form. I (we) certify and represent that the dog entered is not a hazard to persons or other dogs. The entry is submitted for acceptance on the foregoing representation and Agreement. I (we) agree that the club holding this event has the right to refuse this entry for cause which the club shall deem sufficient. In consideration of the acceptance of this entry and of the holding of this event and of the opportunity to have the dog judged and to win prize money, ribbons, or trophies, I (we) agree to hold the AKC, the event giving club, their members, directors, governors, officers, agents superintendents or event secretary and the owner or lessor of the premises and any provider of services that are necessary to hold this event and any employees or volunteers of the aforementioned parties, and any AKC approved judge, judging at this event, harmless from any claim for loss or injury which may be alleged to have been caused directly or indirectly to any person or thing by the act of this dog while in or about the event premises or grounds or near any entrance thereto, and I (we) personally assume all responsibility and liability for any such claim; and I (we) further agree to hold the aforementioned parties harmless from any claim for loss, injury or damage to this dog. Additionally, I (we) hereby assume the sole responsibility for and agree to indemnify, defend and save the aforementioned parties harmless from any and all loss and expense (including legal fees) by reason of the liability imposed by law upon any of the aforementioned parties for damage because of bodily injuries, including death at any time resulting there from, sustained by any person or persons, including myself (ourselves) or on account of damage to property, arising out of or in consequence of my (our) participation in this event, however such, injuries death or property damage may be caused, and whether or not the same may have been caused or may be alleged to have been caused by the negligence of the aforementioned parties or any of their employees, agents, or any other persons. I <b>(WE) AGREE THAT ANY CAUSE OF ACTION, CONTROVERSY OR CLAIM ARISING OUT OF OR RELATED TO THE ENTRY, EXHIBITION OR ATTENDANCE AT THE EVENT BETWEEN THE AKC AND MYSELF (OURSELVES) OR AS TO THE CONSTRUCTION, INTERPRETATION AND EFFECT OF THIS AGREEMENT SHALL BE SETTLED BY ARBITRATION PURSUANT TO THE APPLICABLE RULES OF THE AMERICAN ARBITRATION ASSOCIATION. HOWEVER, PRIOR TO ARBITRATION ALL APPLICABLE AKC BYLAWS, RULES, REGULATIONS AND PROCEDURES MUST FIRST BE FOLLOWED AS SET FORTH IN THE AKC CHARTER AND BYLAWS, RULES, REGULATIONS, PUBLISHED POLICIES AND GUIDELINES.</b>					
Signature of Owner or his Agent duly authorized to make the entry:					
Telephone:		E-mail Address:			
<input type="checkbox"/> Please separate my hounds		<input type="checkbox"/> Check if hound has been dismissed within the last 6 trials entered. Must be marked in order to qualify for a "clean" trial requirement.			

**OFFICIAL AMERICAN KENNEL CLUB LURE COURSING ENTRY FORM**

Club: <b>Chintimini Kennel Club</b>		Date:	Event #:		
Location: <b>Billups' Ranch 71273 London Rd. Cottage Grove, OR 97424</b>		Event type: <input type="checkbox"/> Test <input type="checkbox"/> Trial	I Enclose Entry fees in the amount of : \$ _____		
Class: <input type="checkbox"/> JC <input type="checkbox"/> QC <input type="checkbox"/> Open <input type="checkbox"/> Special <input type="checkbox"/> Veteran <input type="checkbox"/> Single		Breed:			
Breeder:		Reg./List. No:	Sex:	Date of Birth:	
<input type="checkbox"/> AKC No. <input type="checkbox"/> AKC Litter No. <input type="checkbox"/> PAL/ILP No. <input type="checkbox"/> Foreign No. & list country <input type="checkbox"/> Canine Partners.					
Full Name of Dog:			Call Name:		
Sire:					
Dam:					
Actual Owner(s):					
Owner's Address:					
City:		State:	Zip:		
Name of Owner's Agent/Handler (if any at Trial):					
AKC Rules, Regulations, Policies and Guidelines are available on the American Kennel Club website: <a href="http://www.akc.org">www.akc.org</a> <b>AGREEMENT</b> I CERTIFY that I am the actual owner of this dog, or that I am the duly authorized agent of the actual owner whose name I have entered above. In consideration of the acceptance of this entry, I (we) agree to abide by the rules and regulations of The American Kennel Club in effect at the time of this trial, and by any additional rules and regulations appearing in the premium list for this trial, and entry form. I (we) certify and represent that the dog entered is not a hazard to persons or other dogs. The entry is submitted for acceptance on the foregoing representation and Agreement. I (we) agree that the club holding this event has the right to refuse this entry for cause which the club shall deem sufficient. In consideration of the acceptance of this entry and of the holding of this event and of the opportunity to have the dog judged and to win prize money, ribbons, or trophies, I (we) agree to hold the AKC, the event giving club, their members, directors, governors, officers, agents superintendents or event secretary and the owner or lessor of the premises and any provider of services that are necessary to hold this event and any employees or volunteers of the aforementioned parties, and any AKC approved judge, judging at this event, harmless from any claim for loss or injury which may be alleged to have been caused directly or indirectly to any person or thing by the act of this dog while in or about the event premises or grounds or near any entrance thereto, and I (we) personally assume all responsibility and liability for any such claim; and I (we) further agree to hold the aforementioned parties harmless from any claim for loss, injury or damage to this dog. Additionally, I (we) hereby assume the sole responsibility for and agree to indemnify, defend and save the aforementioned parties harmless from any and all loss and expense (including legal fees) by reason of the liability imposed by law upon any of the aforementioned parties for damage because of bodily injuries, including death at any time resulting there from, sustained by any person or persons, including myself (ourselves) or on account of damage to property, arising out of or in consequence of my (our) participation in this event, however such, injuries death or property damage may be caused, and whether or not the same may have been caused or may be alleged to have been caused by the negligence of the aforementioned parties or any of their employees, agents, or any other persons. I <b>(WE) AGREE THAT ANY CAUSE OF ACTION, CONTROVERSY OR CLAIM ARISING OUT OF OR RELATED TO THE ENTRY, EXHIBITION OR ATTENDANCE AT THE EVENT BETWEEN THE AKC AND MYSELF (OURSELVES) OR AS TO THE CONSTRUCTION, INTERPRETATION AND EFFECT OF THIS AGREEMENT SHALL BE SETTLED BY ARBITRATION PURSUANT TO THE APPLICABLE RULES OF THE AMERICAN ARBITRATION ASSOCIATION. HOWEVER, PRIOR TO ARBITRATION ALL APPLICABLE AKC BYLAWS, RULES, REGULATIONS AND PROCEDURES MUST FIRST BE FOLLOWED AS SET FORTH IN THE AKC CHARTER AND BYLAWS, RULES, REGULATIONS, PUBLISHED POLICIES AND GUIDELINES.</b>					
Signature of Owner or his Agent duly authorized to make the entry:					
Telephone:		E-mail Address:			
<input type="checkbox"/> Please separate my hounds		<input type="checkbox"/> Check if hound has been dismissed within the last 6 trials entered. Must be marked in order to qualify for a "clean" trial requirement.			





**AMERICAN  
KENNEL CLUB®**

## Qualified Courser Certificate

**Instructions:** *This form is to be used when a hound successfully completes the Qualified Courser Test at an AKC® Lure Coursing event. A hound must have received this certification within one year of the closing date of the trial being entered to be eligible to compete in an AKC Lure Coursing Trial in the Open or Open Veteran stake. This form must be properly completed and submitted along with this hound's first entry in an AKC Lure Coursing Trial in either stake.*

*\* Hounds who have earned a Field Championship from either the American Sighthound Field Association (ASFA) or the Canadian Kennel Club (CKC) are exempt from this requirement. A copy of the applicable FC certificate must accompany the first entry of these hounds.*

**To be completed by owner/agent:**

Breed \_\_\_\_\_

AKC Registered Name \_\_\_\_\_

AKC Registration Number \_\_\_\_\_

I hereby certify that the hound running in the Qualifying Course is the hound identified above and the information provided is true and correct.

Printed Name of Owner/Agent \_\_\_\_\_

Signature of Owner/Agent \_\_\_\_\_ Date \_\_\_\_\_

---

**To be completed by certifying judge:**

I hereby certify that the above referenced hound passed the Qualified Courser Test by running clean with another hound of the same breed or one with a similar running style completing a course a minimum of 600 yards.

Judge's Printed Name \_\_\_\_\_ Judge's Number \_\_\_\_\_

Judge's Signature \_\_\_\_\_ Date \_\_\_\_\_